

MINI INCUBATOR

with power adaptor

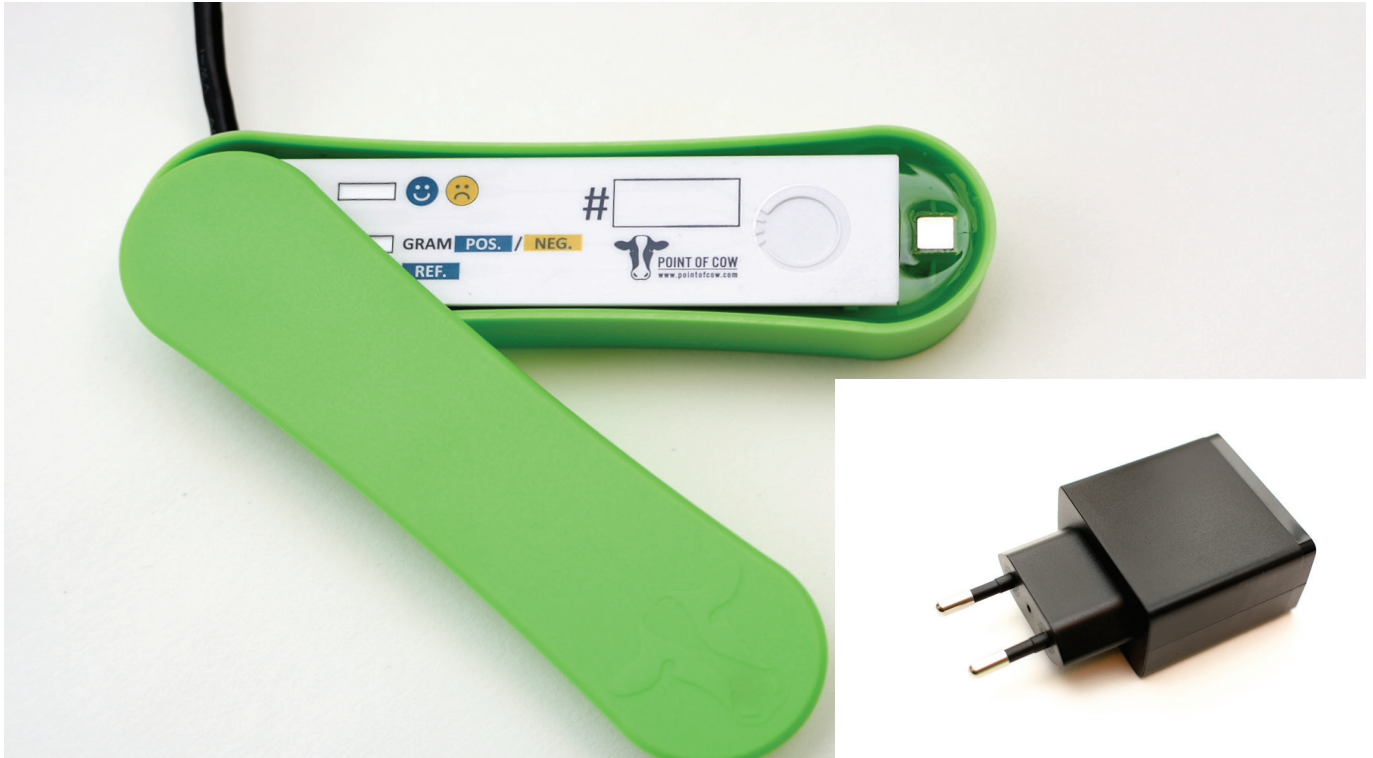

MINI INCUBATOR CONTAINS

- Qty. 1 mini incubator
- Qty. 1 power adaptor

Suitable for

- BACT Gram neg/pos, product number 201

The mini incubator can hold qty. 1 BACT test chip (not included)

The mini incubator controls the conditions around the BACT test chip by warming to 37 °C (body temperature) and any bacteria that was present in the milk when it was placed in the test chip will multiply.

The mini incubator requires very little space. A flashing LED indicates that power is connected and the incubator is operating. The incubator operates at room temperature (17–35 °C) and must be kept away from direct sunlight.



MINI INCUBATOR

with power adaptor

APPLICATION

Extracting the milk sample



Applying the milk sample



Mini incubator



Reading

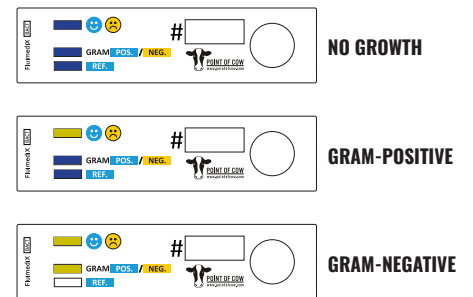

PRODUCT BENEFITS

- Support tool for deciding whether to use or not use antibiotics treatment for a mild mastitis
- Follow-up for determining whether the treatment has had an effect
- Easy to use. No training required
- Fast response – within 16 hours

SPECIFICATIONS

Product code: 301,

Mini incubator with power adapter

Mini incubator with power adapter	Qty. 1
Capacity:	1 BACT
Dimensions (W x L x H):	31 x 119.3 x 20.8 mm
Weight:	96 g/150 g with adapter
Electric power connection:	230 V
Operating voltage:	5 VDC
Power consumption:	Up to 5 W
Ambient temperature:	17–35 °C
	Must not be used in direct sunlight